

LED 36*12W (4IN1-R G B W) Wash Moving Head User Manual



(Please read the instructions carefully before using the product and
properly manage)

Thank you choose to use our factory's LED 36 * 12W (4IN1-R G B W) focus dyeing head shaking. For proper and safe use of this product, please read the instructions carefully before installing this product. This manual contains important installation and application information. Please observe the procedure carefully when installing and operating the product. At the same time, please keep this manual.

Our LED 36 * 12W (4IN1-R G B W) focus on dyeing moving head light using a new beautiful high temperature metal body. This product strictly follows the CE standard design and production, in line with international standards DMX512 signal protocol, can be used alone control, but also online use, with fast rotation, low noise, powerful features for small and medium-sized concerts, theaters, Studios, nightclubs and bars and other places,

This product uses a bright and stable LED 36 * 12W (4IN1-R G B W) lamp beads. Please carefully remove the packaging, after the removal of the package to check whether the product is damaged in the transport process, and check whether the following is complete.

Dyeing lamp: 1 Taiwan

Hanging pieces: 1 Taiwan

Manual: 1 this

Power line : 1 article

Signal line : 1 article

This product is a complete product before leaving the factory. In order to maintain the integrity of the product and ensure safe operation, the user should follow the safety precautions and warnings of this manual.

Important: Damage caused by failure to follow this instruction is not covered by the warranty. The supplier is not responsible for the resulting product.

If the product has been exposed to extreme unstable temperatures (eg after shipping), do not immediately connect the product to the product because the water droplets due to temperature changes may damage the product. Please use the product after returning to normal temperature.

This product can be used in the 90-240V voltage range, is used for indoor products. Please ensure that the use of ground voltage is not higher than the product can withstand the range! The power plug must be plugged into a protective class I socket. Green or tea cyan conductor must be grounded.

Always check this product grade power cord. Make sure that the power cord does not fold or damage the scratches and is not connected to the other wires! Special attention is required when connecting the power cord or the associated connection. Be sure to unplug the power supply before using this product or before cleaning it.

Before using the product, please familiarize yourself with the operation function of the product. Please do not allow children or non-professionals to contact the product. Please do not shake this product. Do not use brute force when installing or operating the product. Do not let non-professionals operate the product. Most of the damage is caused by a non-professional operation.

The product is not equipped with the relevant maintenance accessories. Product maintenance and repair can only be carried out by professionals!

Please do not arbitrarily change the product, otherwise it may damage the product, so the damage is not covered by the warranty. Moreover, non-professional operation may lead to short circuit, burn or electric shock, and so on.

DMX512 signal connection:

This fixture uses the DMX512 signal control mode. Each lamp control signal is connected in parallel. When connecting multiple lamp signals, it is best to use the double-core shielded cable. When connecting, the lamps are connected to the DMX signal jack (XLR) (Input) and OUTPUT (output) are connected. The 3-pin XLR plug terminals of the signal cable connecting the lamps must correspond to each other. When connecting the lamp signal, it is recommended to use the DMX signal terminator. The

DMX signal terminator is a XLR plug between the 2 feet and 3 feet to connect a 120 ohm 1W resistor and connect it to the OUTPUT jack on the last fixture.

Lamp start address code calculation method:

The starting address of the current fixture is equal to (the starting address code of the last fixture) + (the number of channels of the lamp)

1: The starting address code value A001 of the first fixture.

2: The number of basic channels of the controller should be greater than or equal to the total number of channels used for the lamp.

3: Note: When using any controller, each fixture should have its own starting address code, if the first lamp starting address code set A001, lamp channel pass is 16CH; then the second lamp starting address code onSet to A019; third lamp starting address code is set to A037; and so on, (this setting also need to Different console to set)

Lamp installation instructions:

The lamp can be placed horizontally, oblique hanging and upside down, oblique hanging and upside down must pay attention to the installation method. Lamp fixed installation: Before positioning the lamp, to ensure the stability of the installation site, in the reverse hanging installation, must ensure Do not fall on the support frame, use a safety rope to wear the support frame and the lamp handle, to assist the hanging; to ensure safety. To prevent the falling and sliding lamps, lamps and lanterns in the installation and commissioning, the following prohibited pedestrian through, regular inspection of safety Whether the rope wear, hook screw is loose, if the installation is not stable due to hanging, resulting in all the consequences of falling lights, the manufacturer does not assume any responsibility

Installation:

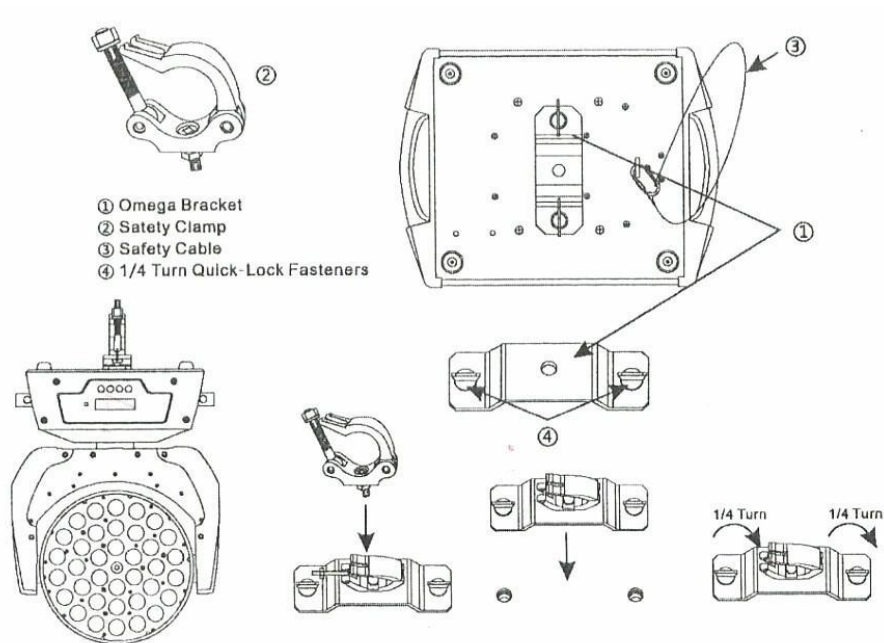

DMX-512 control connection:

Connect the supplied XLR cable to the controller's 3-pin XLR socket and the other end to the 3-pin XLR socket on the mobile head. You can link multiple shaking heads together via a serial link. The required cable should be a two-core shielded cable with XLR input and output connectors. Please refer to the figure below.

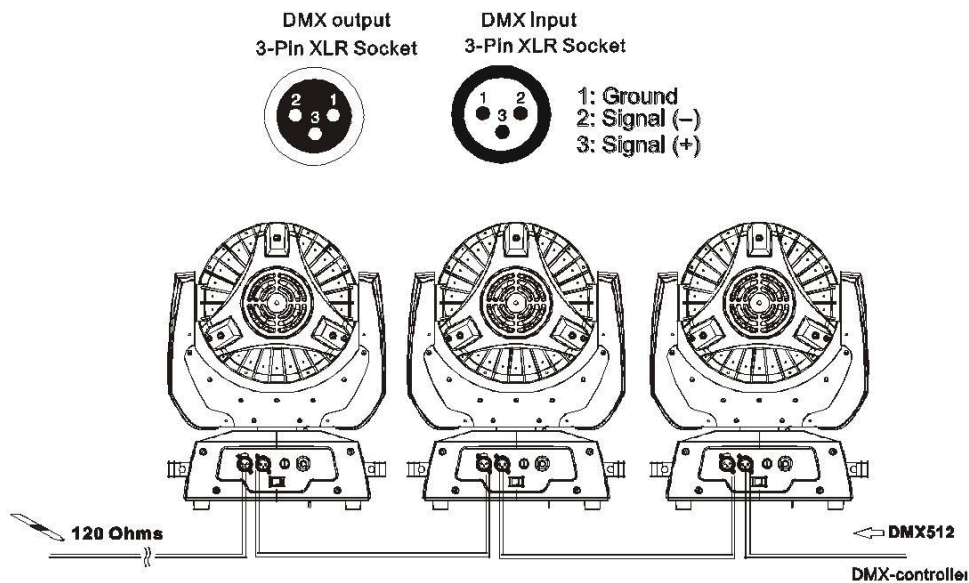

Display description

1. Run Mode Set

Press the "Enter" key to enter the setting, press "UP" key or "DOWN" key to select the working mode, the working mode is followed by "DMX512", "Auto", " Sound ", select the work mode and press "Enter" to save and exit.

DMX512: Console operating mode;

Auto: Automatic running Sound:

Voice - activated mode

2. DMX Address

This option is used to set the DMX communication address, press "Enter" key to enter the setting, press "UP" key to decrease the address number, and then "DOWN" key to increase the address number, select the address and press "Enter" Save and exit.

3. Chanel Mode

This light has only one channel mode: 14 channels.

4. Invert Pan

Press "Enter" to enter the setting. Press "UP" or "DOWN" to select whether the X / Y axis is reverse or not. Select "Yes" to denote X axis reverse, select "NO" that X axis does not reverse, select the direction and press "Enter" to save and exit

5. Invert Tilt

Press "Enter" to enter the setting. Press "UP" or "DOWN" to select whether the X / Y axis is reverse or not. Select "Yes" to denote Y axis reverse, select "NO" that Y axis does not reverse, select the direction and press "Enter" to save and exit.

6. Pan Adjust

This option is to fine-tune the initial position of the X axis. Press the "Enter" key to enter the setting, press the "UP" key or the "DOWN" key to adjust the initial position. After confirming the initial position, press "Enter" to save and exit.

7. Tilt Adjust

This option is to fine-tune the initial position of the Y axis. Press "Enter" to enter the setting, press "UP" or "DOWN" to adjust the initial position. After confirming the initial position, press "Enter" to save and exit.

8. Focus Adjust

This option is to fine-tune the initial position of the Z axis. Press "Enter" to enter the setting, press "UP" or "DOWN" to adjust the initial position. After confirming the initial position, press "Enter" to save and exit.

9. Balance-R

This option is the red LED white balance setting. Press "Enter" to enter the setting. Press "UP" or "DOWN" to adjust the red brightness. The range is 100 ~ 255. After confirming the color brightness, press "Enter" to save and exit.

10. Balance-G

This option is the green LED white balance setting. Press the "Enter" key to enter the setting. Press the "UP" or "DOWN" key to adjust the green brightness. The range is 100 ~ 255. After confirming the color brightness, press "Enter" to save and exit

11. Balance-B

This option is the blue LED white balance setting. Press the "Enter" key to enter the setting. Press the "UP" or "DOWN" key to adjust the blue brightness. The range is 100 ~ 255. After confirming the color brightness, press "Enter". Save and exit.

12. Balance-W

This option is the white LED white balance setting. Press the "Enter" key to enter the setting. Press the "UP" or "DOWN" key to adjust the white brightness. The range is 100 ~ 255. After confirming the color brightness, press "Enter" to save and exit.

13. Backlight

This option is to set the LCD backlight. Press the "Enter" key to enter the setting. For the LCD backlight, press the "UP" or "DOWN" key to select the switch. Select "NO" to indicate that the LCD backlight is always on. Turn off. Selecting "30s" means that it will turn off after 30 seconds without key operation, and then turn on again when there is a key operation. After selecting the settings, press "Enter"

to save and exit.

14. Sound Sense

This option is to set the voice control sensitivity. Press the "Enter" key to enter the setting, press the "UP" key or the "DOWN" key to set the voice control sensitivity, the range is 0 ~ 100%, press "ENTER" to confirm, save and exit.

15. Factory Default

This option is to choose whether to restore the factory settings of the lamp body. Press the "Enter" key to enter the settings, press the "UP" key or the "DOWN" key to select whether to perform the factory reset operation. All parameters are restored to the factory settings and press "ENTER" confirm exit.

16. Reset

This option is the reset selection of the lamp body. Press the "Enter" key to enter the setting, press the "UP" key or the "DOWN" key to select whether to perform the reset operation and press "ENTER" to confirm the exit.

Technical parameters

Voltage: AC90-240v

Power: 400w

Frequency: 50-60Hz

Lamp source: 36 * 12W (4IN1-R G B W)

Channel: 14CH

Control mode: DMX / AUTO/ SOUND

Horizontal scan: 540 ° (16-bit exact scan)

Vertical scan: 270 ° (16-bit exact scan)

Strobe: 1-25 times / sec or random

Display: LCD / English

14CH DMX512 Channel table:

Number	Features	DMXValue	Description
1	Xaxis	0-255	0 ~ 540 degrees
2	Yaxis	0-255	0~270degrees
3	Dimming	0-255	0-100% linear dimming
4	Strobe	0-3	No function
		4-255	Synchronous strobe speed from slow to fast (1HZ ~ 25HZ)
5	R	0-255	0-100%
6	G	0-255	0-100%
7	B	0-255	0-100%
8	W	0-255	0-100%
9	focusing	0-255	0-100% Linear focusing
10	Macro function	0-155	DMX512
		156-199	Auto
		200-255	Sound
11	X axis fine tuning	0-255	0--2.1°
12	Y axis fine tuning	0-255	0--1.0°
13	XY speed	0-255	Speed from fast to slow
14	Reset	0-250	No function
		251-255	Light body reset, 3s effective.

Shutdown operation:

Before shutting down each power off, turn off the lamp in advance for 10 minutes. Let the cooling fan to use the heat generated in the lamp, the rapid discharge, which can extend the accessories within the lamp, especially the lamp life! To ensure that the lamp can be run stably, it should be kept clean, open the lamp for repair or start maintenance work before this first to confirm whether the power is disconnected, keep the lamp clean, clean is very important, please do regular cleaning, not only To maintain the maximum brightness output, but also to extend the life of the lamp, it is recommended to use high-quality glass cleaning agent and use a clean soft cloth to clean the lamp inside the vacuum cleaner at least six months cleaning time.

After-sales service:

Note! Lamps are factory, are subject to strict quality inspection, packaging are in good condition, please follow the instructions to operate. Man-made causes of machine failure is not covered by the warranty.

The company for life to provide technical advice to customers.

If the product fails, need to repair, please produce product warranty card, and truthfully fill in the relevant content. Also hope that customers in a timely manner to the product feedback to us, to facilitate our first time to improve the product.